

# PE series High Precision Planetary Reducer



## 減速機性能資料 REDUCER PERFORMANCE INFORMATION

規格 Model NO.	符號 Symbol	單位 Unit	節數 Stage	減速比 Ratio	42	60	90	115	142	180
額定輸出力矩 Rated Output Torque	T <sub>2N</sub>	Nm	L1	3	17	44	115	225	440	955
				4	17	44	118	231	450	875
				5	16	42	123	228	445	850
				7	13	37	101	206	376	805
				10	11	29	73	163	305	775
			L2	15	16	42	114	221	434	955
				20	17	44	121	238	464	875
				25	16	42	128	236	460	850
				30	16	42	113	220	432	955
				35	13	37	105	214	392	805
				40	17	45	122	240	469	875
				50	16	42	128	236	460	850
				70	13	37	105	214	392	805
				100	11	29	75	170	318	775
最大輸入轉速 Max. Input Speed	n <sub>1B</sub>	rpm	L1 / L2	3~100	8,000	6,000	6,000	4,800	3,600	3,000
額定輸入轉速 Rated Input Speed	n <sub>1N</sub>	rpm	L1 / L2	3~100	4,500	4,000	3,600	3,600	2,500	2,000
標準背隙 Backlash	-	arcmin	L1	3~10	≤8					
			L2	15~100	≤12					
最大加速扭矩 Max. Acceleration Torque	T <sub>2B</sub>	Nm	L1 / L2	3~100	1.8倍額定輸出力矩 / 1.8 Times Of Nominal Output Torque					
最大輸出(急停)扭矩 Max. Output(Emergency Stop) Torque	T <sub>2NOT</sub>	Nm	L1 / L2	3~100	3倍額定輸出力矩 / 3 Times Of Nominal Output Torque					
扭轉剛性 Torsional Rigidity	-	Nm/arcmin	L1 / L2	3~100	3	7	14	25	50	140
容許徑向力 Max. Radial Force	F <sub>2rB</sub>	N	L1 / L2	3~100	810	1,150	1,530	3,260	4,550	11,150
容許軸向力 Max. Axial Force	F <sub>2aB</sub>	N	L1 / L2	3~100	405	575	765	1,630	2,275	5,575
使用壽命 Service Life	hr	hr	L1 / L2	3~100	S5週期運轉 > 20,000 ; (S1連續運轉 > 10,000 hrs) S5 Cycle Operation ; > 20,000 (S1 Continuous Operation ; > 10,000 hrs)					
使用溫度 Operation Temperature	-	°C	L1 / L2	3~100	-25°C ~ 90°C					
效率 Efficiency	η	%	L1	3~10	≤97					
			L2	15~100	≤94					
潤滑 Lubrication	-	-	L1 / L2	3~100	合成潤滑油脂 / Synthetic Lubrication Grease					
噪音值 Noise Level	-	dB	L1	3~10	≤60	≤62	≤64	≤66	≤68	≤70
			L2	15~100	≤60	≤62	≤64	≤66	≤68	≤72
防護等級 Protection Class	-	IP	L1 / L2	3~100	IP 65					
安裝方向 Mounting Position	-	-	L1 / L2	3~100	任意方向 / Any Direction					
重量 Weight	-	kg	L1	3~10	0.6	1.4	3.3	6.9	13	38
			L2	15~100	0.9	1.6	4.7	8.7	17	48

## 減速機轉動慣量 REDUCER MOMENT OF INERTIA

規格 Model NO.	符號 Symbol	單位 Unit	節數 Stage	減速比 Ratio	42	60	90	115	142	180
轉動慣量 Moment of Inertia	J <sub>1</sub>	kg.cm <sup>2</sup>	L1	3	0.04	0.14	0.61	3.25	8.75	24.63
				4	0.04	0.13	0.48	2.74	7.16	20.12
				5	0.04	0.11	0.47	2.74	6.84	19.80
				7	0.04	0.11	0.44	2.58	6.78	19.21
				10	0.04	0.11	0.44	2.57	6.68	19.13
			L2	15	0.04	0.14	0.61	3.25	8.75	24.63
				20	0.04	0.13	0.48	2.74	7.16	20.12
				25	0.04	0.11	0.47	2.74	6.84	19.80
				30	0.04	0.14	0.61	3.25	8.75	24.63
				35	0.04	0.11	0.44	2.58	6.78	19.21
				40	0.04	0.11	0.48	2.74	7.16	20.12
				50	0.04	0.11	0.47	2.74	6.84	19.80
				70	0.04	0.11	0.44	2.58	6.78	19.21
				100	0.04	0.11	0.44	2.57	6.68	19.13

**MODEL: PE SERIES L1-Stage (Ratio: 3~10)**

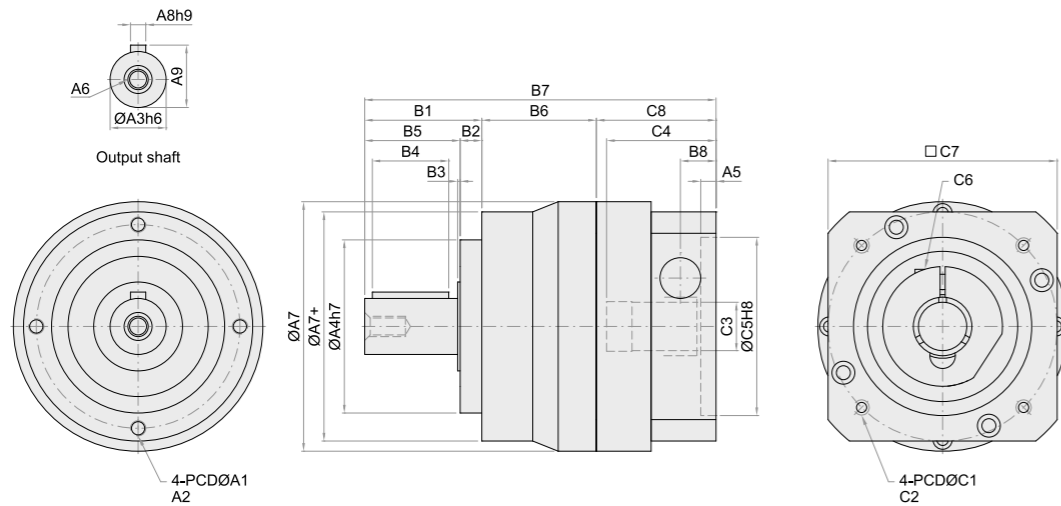

Model	Code	42	60	90	115	142	180
A1		44	62	80	108	140	184
A2		M4 x P0.7	M5 x P0.8	M6 x P1	M6 x P1	M10 x P1.25	M12 x P1.75
A3		13	16	22	32	40	55
A4		35	52	68	90	120	160
A5		6	6	6	7	7	8
A6		M4 x P0.7	M5 x P0.8	M8 x P1.25	M12 x P1.75	M16 x P2.0	M20 x P2.5
A7		59	70	98	125	156	213
A7+		50	70	90	120	156	213
A8		5	5	6	10	12	16
A9		15	18	24.5	35	43	59
B1		24.5	36.5	46	70	97	104.5
B2		4	6.5	8.5	17	15	20
B3		1.6	1.5	1	2	3	2.5
B4		15	25	30	40	60	70
B5		20.5	30	37.5	53	82	84.5
B6		29.8	33.5	45	49	72	87.5
B7		88.8	114	138	190	251	292
B8		11	10.5	14	30	23	27.5
C1		46	70	90	145	165	200
C2		M4 x P0.7	M5 x P0.8	M6 x P1	M8 x P1.25	M10 x P1.5	M12 x P1.75
C3		8	14   19	19   24	24   35	35   42	42
C4		26.3	34.3	43	68.2	69	81.5
C5		30	50	70	110	130	114.3
C6		M3 x P0.5	M5 x P0.8	M6 x P1.0	M8 x P1.25	M10 x P1.5	M12 x P1.75
C7		42.6	60	90	130	142	180
C8		34.5	44	47	71	82	100

**MODEL: PE SERIES L2-Stage (Ratio: 15~100)**

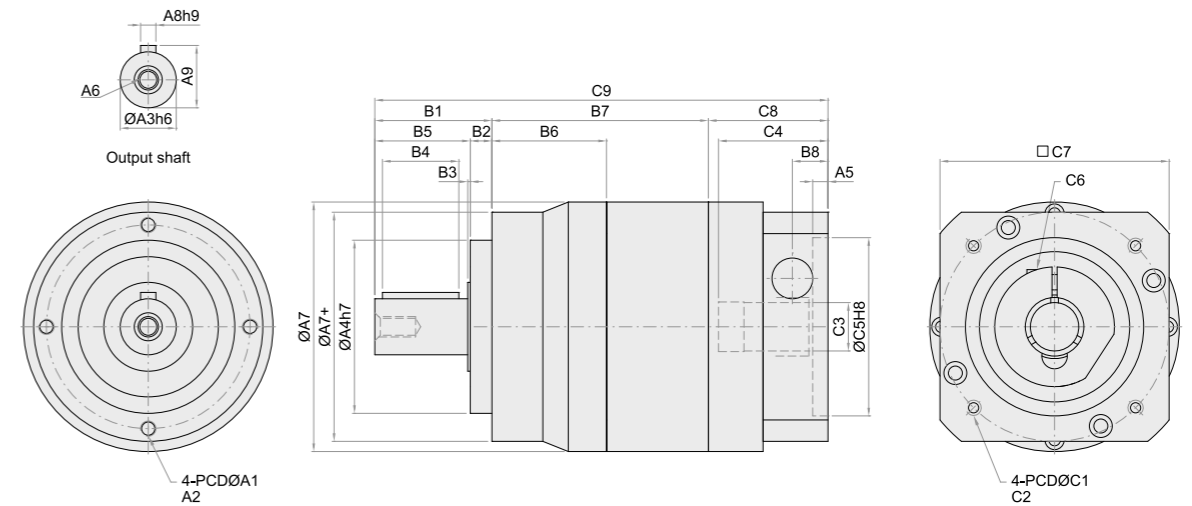

Model	Code	42	60	90	115	142	180
A1		44	62	80	108	140	184
A2		M4 x P0.7	M5 x P0.8	M6 x P1	M6 x P1	M10 x P1.25	M12 x P1.75
A3		13	16	22	32	40	55
A4		35	52	68	90	120	160
A5		6	6	6	7	7	8
A6		M4 x P0.7	M5 x P0.8	M8 x P1.25	M12 x P1.75	M16 x P2.0	M20 x P2.5
A7		59	70	98	125	156	213
A7+		50	70	90	120	156	213
A8		5	5	6	10	12	16
A9		15	18	24.5	35	43	59
B1		24.5	36.5	46	70	97	104.5
B2		4	6.5	8.5	17	15	20
B3		1.6	1.5	1	2	3	2.5
B4		15	25	30	40	60	70
B5		20.5	30	37.5	53	82	84.5
B6		29.8	33.5	45	49	72	87.5
B7		55.8	61.5	85	97	148	177.5
B8		11	10.5	14	30	23	27.5
C1		46	70	90	145	165	200
C2		M4 x P0.7	M5 x P0.8	M6 x P1	M8 x P1.25	M10 x P1.5	M12 x P1.75
C3		8	14   19	19   24	24   35	35   42	42
C4		26.3	34.3	43	68.2	69	81.5
C5		30	50	70	110	130	114.3
C6		M3 x P0.5	M5 x P0.8	M6 x P1.0	M8 x P1.25	M10 x P1.5	M12 x P1.75
C7		42.6	60	90	130	142	180
C8		34.5	44	47	71	82	100
C9		114.8	142	178	238	312	382