



ST series High Precision Planetary Reducer

減速機性能資料 REDUCER PERFORMANCE INFORMATION

規格 Model NO.	符號 Symbol	單位 Unit	節數 Stage	減速比 Ratio	60	90	110	142
額定輸出力矩 Rated Output Torque	T _{2N}	Nm	L1	3	25	78	150	360
				4	25	78	150	360
				5	25	78	150	360
				10	24	68	150	360
				20	24	68	150	360
			L2	15	25	78	150	360
				25	25	78	150	360
				30	24	68	150	360
				40	24	68	150	360
				50	25	78	150	360
最大輸入轉速 Max. Input Speed	n _{1B}	rpm	L1 / L2	3~50	10,000	10,000	8,000	8,000
額定輸入轉速 Rated Input Speed	n _{1N}	rpm	L1 / L2	3~50	5,000	5,000	4,000	4,000
超精密背隙 P0 Backlash P0	-	arcmin	L1	3~20	≤4			
			L2	15~50	≤6			
精密背隙 P1 Backlash P1	-	arcmin	L1	3~20	≤7			
			L2	15~50	≤9			
精密背隙 P2 Backlash P2	-	arcmin	L1	3~20	≤10			
			L2	15~50	≤12			
最大加速扭矩 Max. Acceleration Torque	T _{2B}	Nm	L1 / L2	3~50	1.5倍額定輸出力矩 / 1.5 Times of nominal output torque			
最大輸出(急停)扭矩 Max. Output(Emergency Stop) Torque	T _{2NOT}	Nm	L1 / L2	3~50	3倍額定輸出力矩 / 3 Times of nominal output torque			
容許徑向力 Max. Radial Force	F _{2rB}	N	L1 / L2	3~50	600	1,000	2,000	3,000
容許軸向力 Max. Axial Force	F _{2aB}	N	L1 / L2	3~50	300	500	1,000	1,500
使用壽命 Service Life	hr	hr	L1 / L2	3~50	S5週期運轉 > 20,000 ; (S1連續運轉 > 10,000 hrs) S5 Cycle Operation : > 20,000 (S1 Continuous Operation : > 10,000 hrs)			
使用溫度 Operation Temperature	-	°C	L1 / L2	3~50	-25°C ~ 90°C			
效率 Efficiency	η	%	L1	3~20	≤94			
			L2	15~50	≤90			
潤滑 Lubrication	-	-	L1 / L2	3~50	合成潤滑油脂 / Synthetic Lubrication Grease			
噪音值 Noise Level	-	dB	L1	3~20	≤68	≤73	≤74	≤75
			L2	15~50	≤71	≤76	≤77	≤78

減速機轉動慣量 REDUCER MOMENT OF INERTIA

規格 Model NO.	符號 Symbol	單位 Unit	節數 Stage	減速比 Ratio	60	90	110	142
轉動慣量 Moment of Inertia	J ₁	kg.cm ²	L1	3	0.05	0.18	0.41	0.56
				4	0.05	0.18	0.41	0.56
				5	0.05	0.18	0.41	0.56
				10	0.05	0.18	0.41	0.56
				20	0.05	0.18	0.41	0.56
			L2	15	0.05	0.18	0.41	0.56
				25	0.05	0.18	0.41	0.56
				30	0.05	0.16	0.38	0.53
				40	0.05	0.16	0.38	0.53
				50	0.05	0.16	0.38	0.53

MODEL: ST SERIES L1-Stage (Ratio: 3~20)

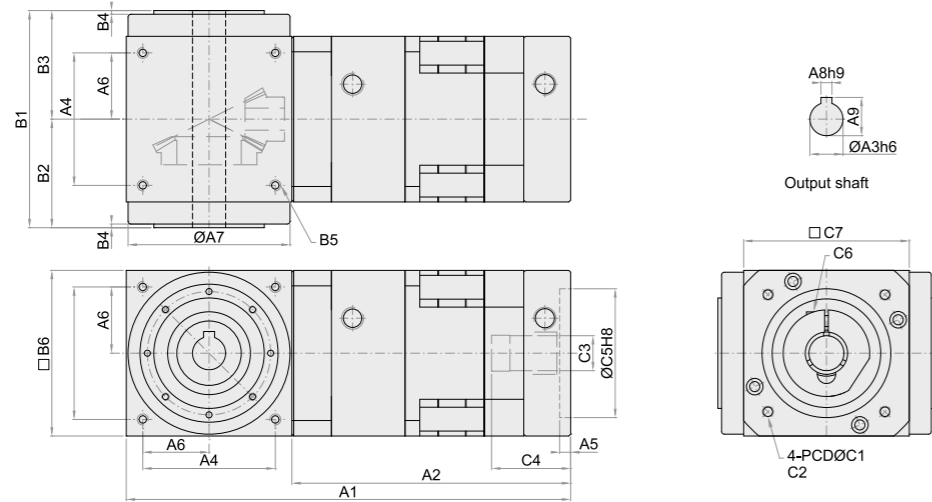

Model \ Code	60	70	90	110	142	200
A1	142	147	241.5	279.5	404	455
A2	77	77	151.5	169.5	262	255
A3	14	16	18	22	40	80
A4	52	42.43	72	88	110	129
A5	6	6	6	7	7	7
A6	26	26.52	36	44	55	64.5
A7	62	60	88	106	135	195
A8	5	-	6	8	-	-
A9	16.3	-	20.8	25.3	-	-
B1	87	122	118	144	188	220.5
B2	43.5	66.9	59	72	91	119.5
B3	43.5	55.1	59	72	97	101
B4	1	3.5	2	2	1 7	20 1.5
B5	M5 x P0.8	M5 x P0.8	M6 x P1.0	M8 x P1.25	M10 x P1.5	M14 x P2.0
B6	65	70	90	110	142	200
C1	70	70	90	145	165	165
C2	M5 x P0.8	M5 x P0.8	M6 x P1.0	M8 x P1.25	M10 x P1.5	M10 x P1.5
C3	14 19	14 19	19 24	24 35	35 42	35 42
C4	34.3	34.3	43	68.2	68.1	68.1
C5	50	50	70	110	130	130
C6	M5 x P0.8	M5 x P0.8	M6 x P1.0	M8 x P1.25	M10 x P1.5	M10 x P1.5
C7	60	60	90	130	142	142

MODEL: ST SERIES L2-Stage (Ratio: 15~50)

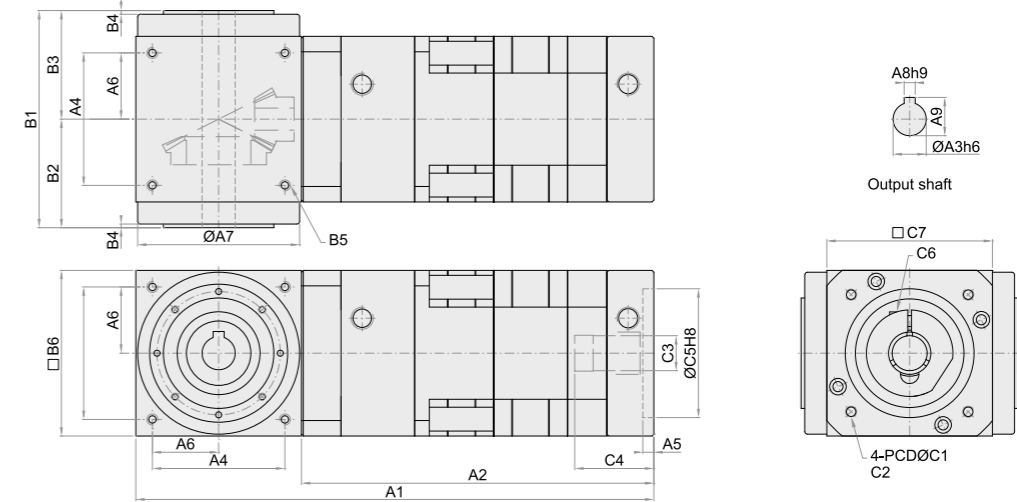

Model \ Code	60	70	90	110	142	200
A1	170	175	281.5	319.5	465	516
A2	105	105	191.5	209.5	323	316
A3	14	16	18	22	40	80
A4	52	42.43	72	88	110	129
A5	6	6	6	7	7	7
A6	26	26.52	36	44	55	84.9
A7	62	60	88	106	135	195
A8	5	-	6	8	-	-
A9	16.3	-	20.8	25.3	-	-
B1	87	122	118	144	188	220.5
B2	43.5	66.9	59	72	91	119.5
B3	43.5	55.1	59	72	97	101
B4	1	3.5	2	2	1 7	20 1.5
B5	M5 x P0.8	M5 x P0.8	M6 x P1.0	M8 x P1.25	M10 x P1.5	M14 x P2.0
B6	65	70	90	110	142	200
C1	70	70	90	145	165	165
C2	M5 x P0.8	M5 x P0.8	M6 x P1.0	M8 x P1.25	M10 x P1.5	M10 x P1.5
C3	14 19	14 19	19 24	24 35	35 42	35 42
C4	34.3	34.3	43	68.2	68.1	68.7
C5	50	50	70	110	130	130
C6	M5 x P0.8	M5 x P0.8	M6 x P1.0	M8 x P1.25	M10 x P1.5	M10 x P1.5
C7	60	60	90	130	142	142