

SD/T series

High Precision Planetary Reducer



減速機性能資料 REDUCER PERFORMANCE INFORMATION

規格 Model NO.	符號 Symbol	單位 Unit	節數 Stage	減速比 Ratio	47	64	90	110	140	200
額定輸出力矩 Rated Output Torque	T _{2N}	Nm	L1	4	20	55	155	330	640	1,950
				5	23	50	150	328	620	1,180
				7	20	45	145	308	560	1,115
				10	15	43	130	290	540	1,050
				20	20	58	157	330	645	1,190
			L2	25	23	55	153	338	615	1,180
				35	20	52	145	308	573	1,115
				40	20	55	158	330	648	1,190
				50	23	48	150	338	615	1,180
				70	20	45	145	308	570	1,115
100	15	42	130	290	540	1,052				
最大輸入轉速 Max. Input Speed	n _{1B}	rpm	L1 / L2	4~100	10,000	10,000	8,000	8,000	6,000	6,000
額定輸入轉速 Rated Input Speed	n _{1N}	rpm	L1 / L2	4~100	5,000	5,000	4,000	4,000	3,000	3,000
超精密背隙 PS Backlash PS	-	arcmin	L1	4~10	≤1					
			L2	20~100	≤3					
精密背隙 P0 Backlash P0	-	arcmin	L1	4~10	≤3					
			L2	20~100	≤5					
精密背隙 P1 Backlash P1	-	arcmin	L1	4~10	≤5					
			L2	20~100	≤7					
最大加速扭矩 Max. Acceleration Torque	T _{2B}	Nm	L1 / L2	4~100	1.8倍額定輸出力矩 / 1.8 Times Of Nominal Output Torque					
最大輸出(急停)扭矩 Max. Output(Emergency Stop)Torque	T _{2NOT}	Nm	L1 / L2	4~100	3倍額定輸出力矩 / 3 Times Of Nominal Output Torque					
扭轉剛性 Torsional Rigidity	-	Nm/arcmin	L1 / L2	4~100	7	13	31	82	151	440
最大彎曲力矩 Max. Bending Moment	M _{2K8}	Nm	L1 / L2	4~100	43	125	235	430	1,300	3,064
容許軸向力 Max. Axial Force	F _{2aB}	N	L1 / L2	4~100	990	1,050	2,850	2,990	10,590	16,660
使用壽命 Service Life	hr	hr	L1 / L2	4~100	S5週期運轉 > 20,000 ; (S1連續運轉 > 10,000 hrs) S5 Cycle Operation ; > 20,000 (S1 Continuous Operation ; > 10,000 hrs)					
使用溫度 Operation Temperature	-	°C	L1 / L2	4~100	-25°C ~ 90°C					
效率 Efficiency	η	%	L1	4~10	≤97					
			L2	20~100	≤94					
潤滑 Lubrication	-	-	L1 / L2	4~100	合成潤滑油脂 / Synthetic Lubrication Grease					
噪音值 Noise Level	-	dB	L1 / L2	4~100	≤56	≤58	≤60	≤63	≤65	≤67
防護等級 Protection Class	-	IP	L1 / L2	4~100	IP 65					
安裝方向 Mounting Position	-	-	L1 / L2	4~100	任意方向 / Any Direction					
重量 Weight	-	kg	L1	4~10	0.7	1.4	4.2	7.4	13.9	32.4
			L2	20~100	1	1.9	4.8	9.4	16.7	40.2

減速機轉動慣量 REDUCER MOMENT OF INERTIA

規格 Model NO.	符號 Symbol	單位 Unit	節數 Stage	減速比 Ratio	47	64	90	110	140	200
轉動慣量 Moment of Inertia	J ₁	kg.cm ²	L1	4	0.03	0.14	0.51	2.87	7.54	25.03
				5	0.03	0.13	0.47	2.71	7.42	23.29
				7	0.03	0.13	0.45	2.62	7.14	22.48
				10	0.03	0.13	0.44	2.57	7.03	22.51
				20	0.03	0.03	0.13	0.47	2.71	7.42
			L2	25	0.03	0.03	0.13	0.47	2.71	7.42
				35	0.03	0.03	0.13	0.47	2.71	7.42
				40	0.03	0.03	0.13	0.44	2.57	7.03
				50	0.03	0.03	0.13	0.44	2.57	7.03
				70	0.03	0.03	0.13	0.44	2.57	7.03
100	0.03	0.03	0.13	0.44	2.57	7.03				

MODEL: SD / T SERIES L1-Stage (Ratio: 4~10)

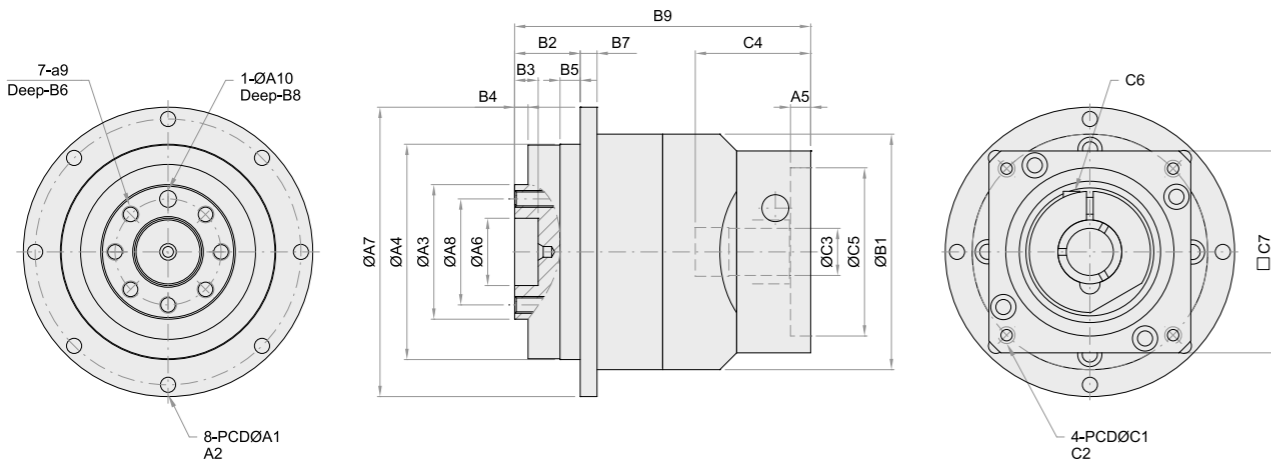

Model	Code	47	64	90	110	140	200
A1		67	79	109	135	168	233
A2		3.4	4.5	5.5	5.5	6.6	9
A3		28	40	63	80	100	160
A4		47	64	90	110	140	200
A5		6	6	6	7	7	8
A6		12	20	31.5	40	50	80
A7		72	86	118	146	179	248
A8		20	31.5	50	63	80	125
A9		4-M3 x P0.5	7-M5 x P0.8	7-M6 x P1.0	11-M6 x P1.0	11-M8 x P1.25	11-M10 x P1.5
A10		3	5	6	6	8	10
B1		59	70	98	125	156	212
B2		18	19.5	30	29	44	50
B3		5	7	12	12	12	16
B4		1.5	4	6	6	6	8
B5		5	6	10	10	15	15
B6		8	13	18	18	24	24
B7		4	5	7	8	10	12
B8		4	7	8	10	10	10
B9		69.8	88	106	149	175	228.5
C1		46	70	90	145	165	200
C2		M4 x P0.7	M5 x P0.8	M6 x P1.0	M8 x P1.25	M10 x P1.5	M12 x P1.75
C3		8	14 19	19 24	24 28	35 42	42
C4		25.8	34.3	43	68.2	68.1	72.5
C5		30	50	70	110	130	114.3
C6		M3 x P0.5	M5 x P0.8	M6 x P1.0	M8 x P1.25	M10 x P1.5	M12 x P1.75
C7		42.6	60	90	130	142	180

MODEL: SD / T SERIES L2-Stage (Ratio: 20~100)

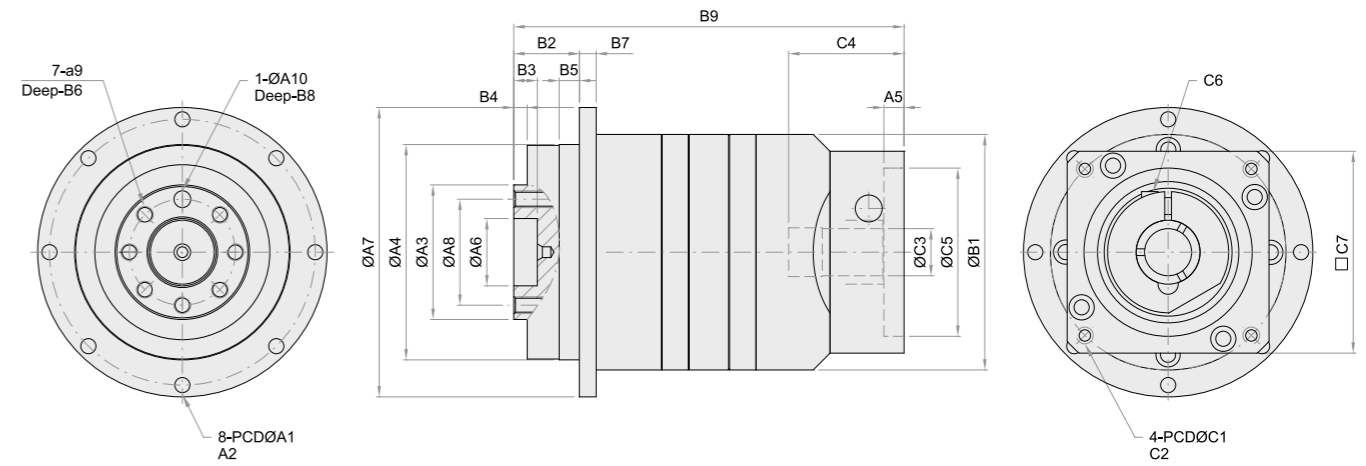

Model	Code	47	64	90	110	140	200
A1		67	79	109	135	168	233
A2		3.4	4.5	5.5	5.5	6.6	9
A3		28	40	63	80	100	160
A4		47	64	90	110	140	200
A5		6	6	6	7	7	8
A6		12	20	31.5	40	50	80
A7		72	86	118	146	179	248
A8		20	31.5	50	63	80	125
A9		4-M3 x P0.5	7-M5 x P0.8	7-M6 x P1.0	11-M6 x P1.0	11-M8 x P1.25	11-M10 x P1.5
A10		3	5	6	6	8	10
B1		59	70	98	125	156	212
B2		18	19.5	30	29	44	50
B3		5	7	12	12	12	16
B4		1.5	4	6	6	6	8
B5		5	6	10	10	15	15
B6		8	13	18	18	24	24
B7		4	5	7	8	10	12
B8		4	7	8	10	10	10
B9		95.8	116	146	197	236	318.5
C1		46	70	90	145	165	200
C2		M4 x P0.7	M5 x P0.8	M6 x P1.0	M8 x P1.25	M10 x P1.5	M12 x P1.75
C3		8	14 19	19 24	24 28	35 42	42
C4		25.8	34.3	43	68.2	68.1	72.5
C5		30	50	70	110	130	114.3
C6		M3 x P0.5	M5 x P0.8	M6 x P1.0	M8 x P1.25	M10 x P1.5	M12 x P1.75
C7		42.6	60	90	130	142	180